

TECHNICAL SHEET for fireplace insert

Novara

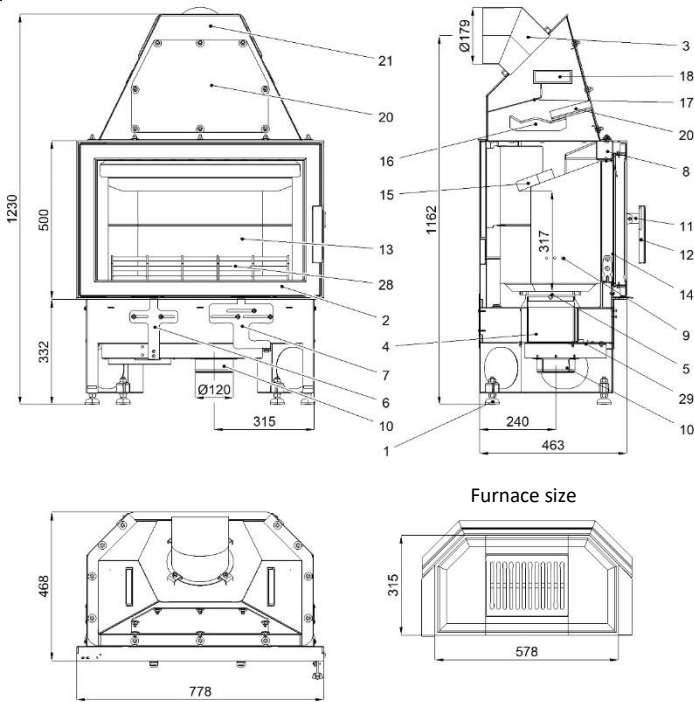

Novara 17 with exchanger

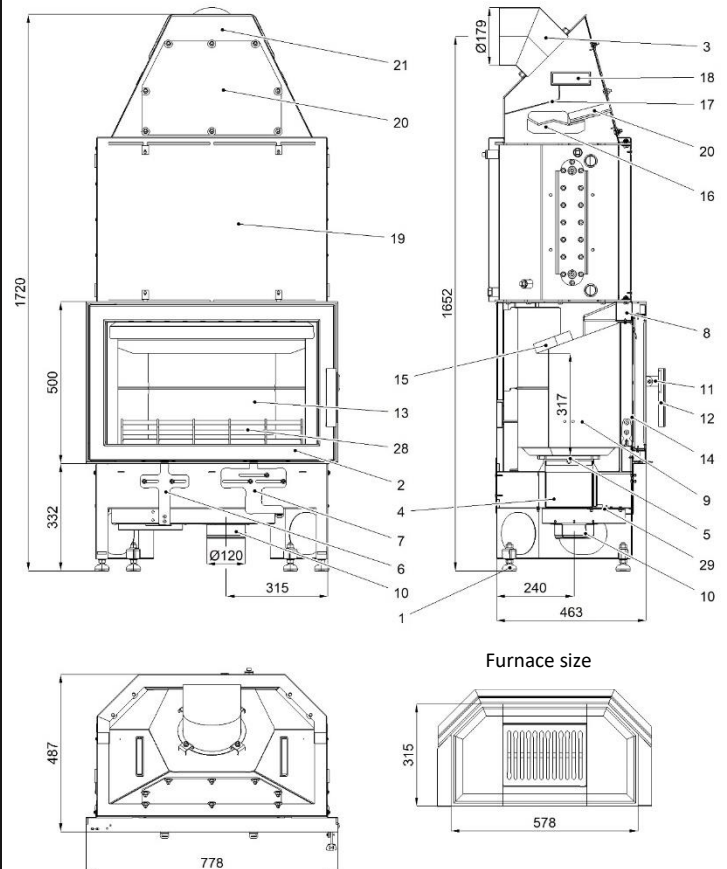

Suitable fuel:
As concerns suitable fuel to be employed, see the chapter **2.2 Fuel** in the General Manual of Operation.

Proper operation:
As concerns the proper and safe operation of the fireplace stove, see the chapters **2. Description of the combustion process** and **5. Operating instructions** in the General Manual of Operation.

TECHNICAL DESCRIPTION:

Pos.	Name	Goods No.	Pos.	Name	Goods No.
1	Adjustable foot	0530513005066	16	Lower lip – fixed	-
2	Fire-box door	0618018275300	17	Middle lip - fixed	-
3	Smoke flue neck (adjustable)	0618018016002	18	Upper lip - fixed	-
4	Ash pan	0618018075410	19	Heat exchanger	0618018073200
5	Grate	0618018075070	20	Cleaning cover	0618018075115
6	Controller of primary air	0618018075041	21	Chimney cap	0618018075100
7	Controller of secondary and tertiary air	0618018075043	28	Protection	0618618015820
8	Intake of secondary air	-	29	Automatic air control (flap)	0431317006601
9	Tertiary air output	-		Seal heat exchanger 20x4 mm (2120 mm)	0040220040005
10	External intake of air (Ø120)	-		Seal fire-box door 10 (2220 mm)	0040300100005
11	Crank	0618018105320		Seal glass with printing 10 (2230 mm)	0040300100005
12	Handle			Seal refractory glass 10x4 (2120 mm)	0040210040005
13	Glass with printing	0618018035301		Glass holder sealing 8x2 (1000 mm)	0040208020006
14	Refractory glass	0618018025301		Seal smoke flue neck 10x4 (570 mm)	0040210040005
15	Lower lip - loose	0618018075701		Seal cleaning cover 10x4 (1040 mm)	0040210040005

TECHNICAL INFORMATION

Novara

Fuel	Output of the heating device					
	100%	33%	100%	33%	100%	33%
	Amount of fuel		Primary air		Secondary and tertiary air	
Saw-dust briquettes	3,5 kg/h	1,2 kg/h	open 20%	open 5%	open 30%	open 10%

TECHNICAL DATA:	Saw-dust briquettes		
Achieved heat output (100%)	12,2 kW	Height	1230 mm
Reduced heat output (33%)	4 kW	Width	778 mm
Maximum stoking amount of the fuel	3,5 kg/h	Depth	527 mm
Average temperature of combustion products behind the smoke flue neck	307 °C	Diameter of the smoke flue	180 mm
Maximum mass flow of dry combustion products	10 g/s	Weight	179 kg
Energy efficiency	78,3 %	Minimum draft in the smoke flue neck	12 Pa
Average concentration of CO ₂	10,5 %	Heating capacity (middle heat losses) at 12,2 kW	cca. 229 m ³
Concentration of CO in combustion products at 13% O ₂	≤ 1500 mg/m ³	Controllable output	3 – 12,2 kW
Dust at 13% O ₂	≤ 40 mg/m ³		
Amount of combustion air at nominal output	30 m ³ /h		
Tested according to EN 13229			

Novara 17 with exchanger

Opaf	Output of the heating device					
	100%	33%	100%	33%	100%	33%
	Amount of fuel		Primary air		Secondary and tertiary air	
Blockwood	4,5 kg/h	1,5 kg/h	closed	closed	open 100%	open 50%

TECHNICAL DATA:	Blockwood		
Achieved heat output (100%)	17,4 kW	Height	1720 mm
Reduced heat output (33%)	5,7 kW	Width	778 mm
Output delivered by the stove body only	6,6 kW	Depth	566 mm
Output available for heating of water	10,8 kW	Diameter of the smoke flue	180 mm
Maximum stoking amount of the fuel	4,5 kg/h	Weight	292 kg
Average temperature of combustion products behind the smoke flue neck	166 °C	Minimum draft in the smoke flue neck	12 Pa
Maximum mass flow of dry combustion products	10,3 g/s	Maximum operating over-pressure of the exchanger	0,2 MPa
Energy efficiency	90,5 %	Water contents of the exchanger	74 l
Average concentration of CO ₂	12,5 %	Recommended heat gradient (t output – t input)	75 - 60 °C
Concentration of CO in combustion products at 13% O ₂	≤ 1500 mg/m ³	Maximum temperature of output water	80 °C
Dust at 13% O ₂	≤ 40 mg/m ³	Heating capacity (middle heat losses) at 17,4 kW	cca. 313 m ³
Amount of combustion air at nominal output	30 m ³ /h	Controllable output	5,1 – 17,4 kW
Tested according to EN 13229			

Monuting the discharge safety device

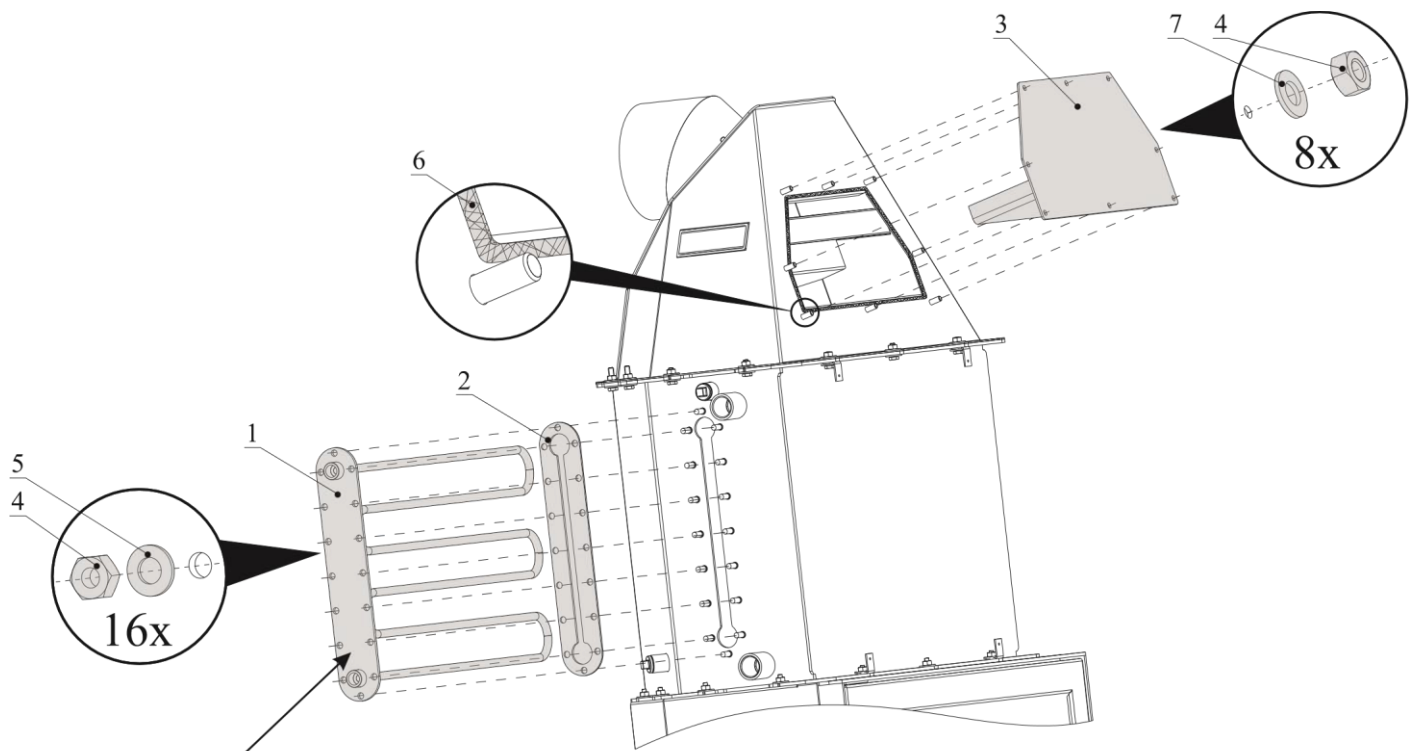

**Coolant loop
(included in the delivery)**

**TEMPERATURE SAFETY VALVE (Example STS20)
(not included in the scope of the delivery)**

Pos.	Name	Goods No.
1	Coolant loop	0618018076020
2	Loop sealing	0618018076016
3	Cleaning cover	0618018075115
4	Nut M8	0032000800006
5	Washer 8,4	0033050840006
6	Seal cleaning cover 10x4	0040210040005
7	Washer 8,4	0033000840006

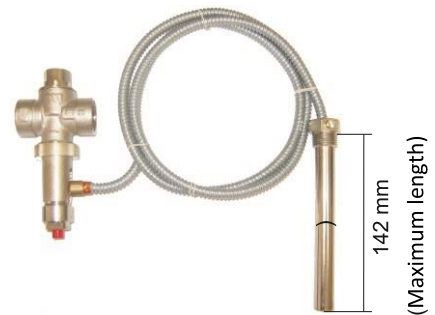

Instructions for installation and removal of the exchanger

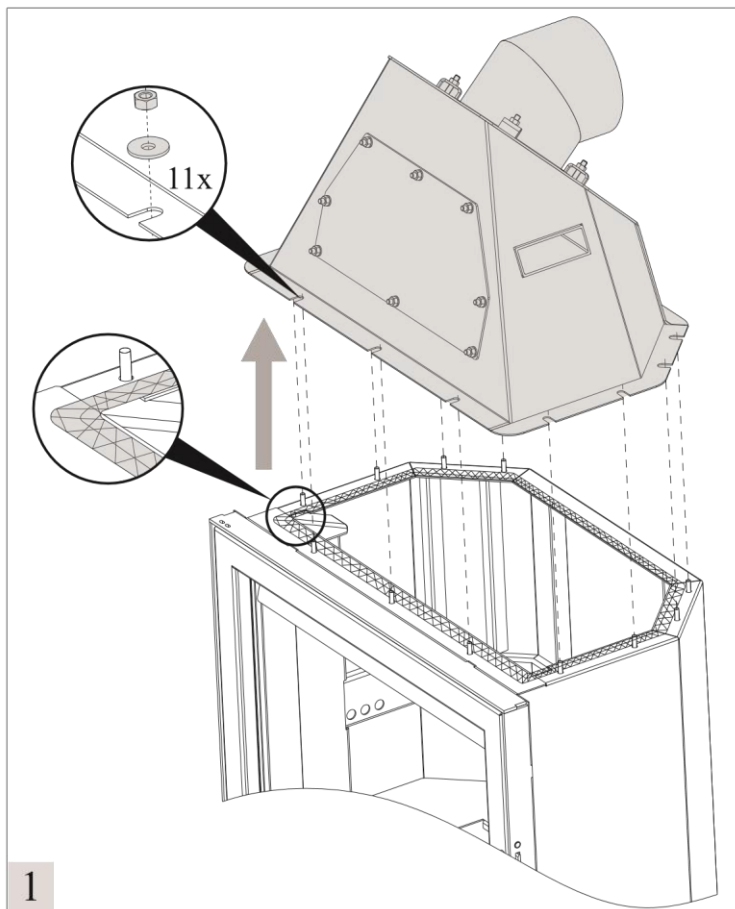

1

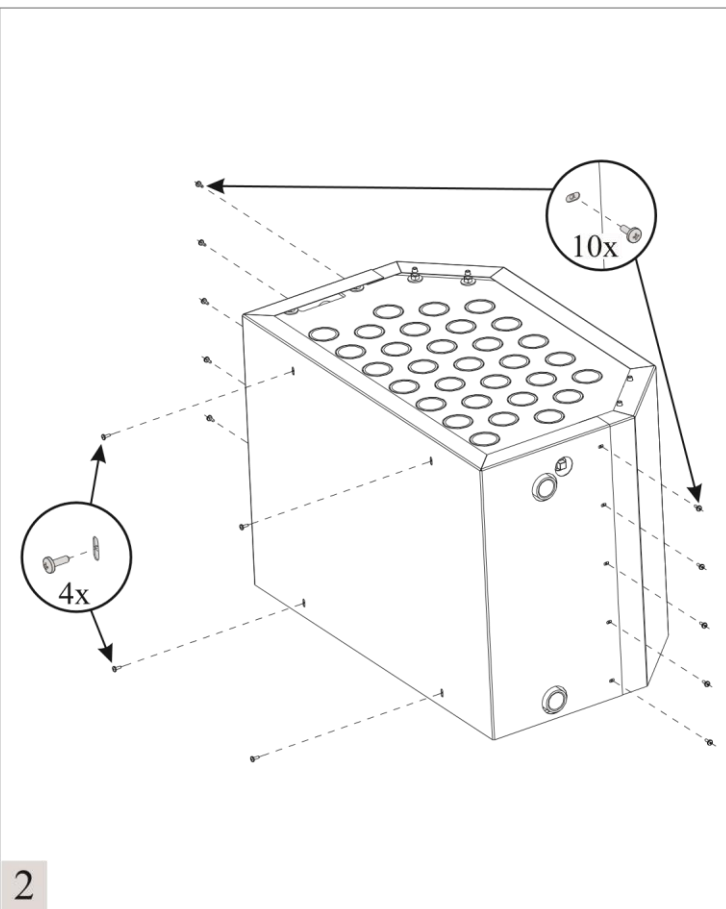

2

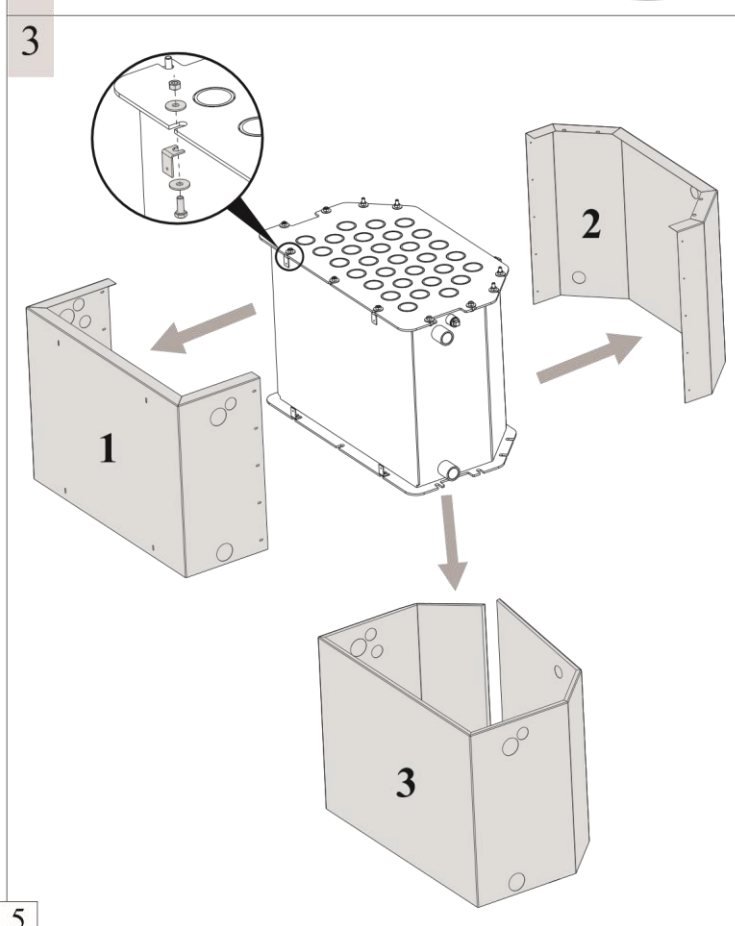

3

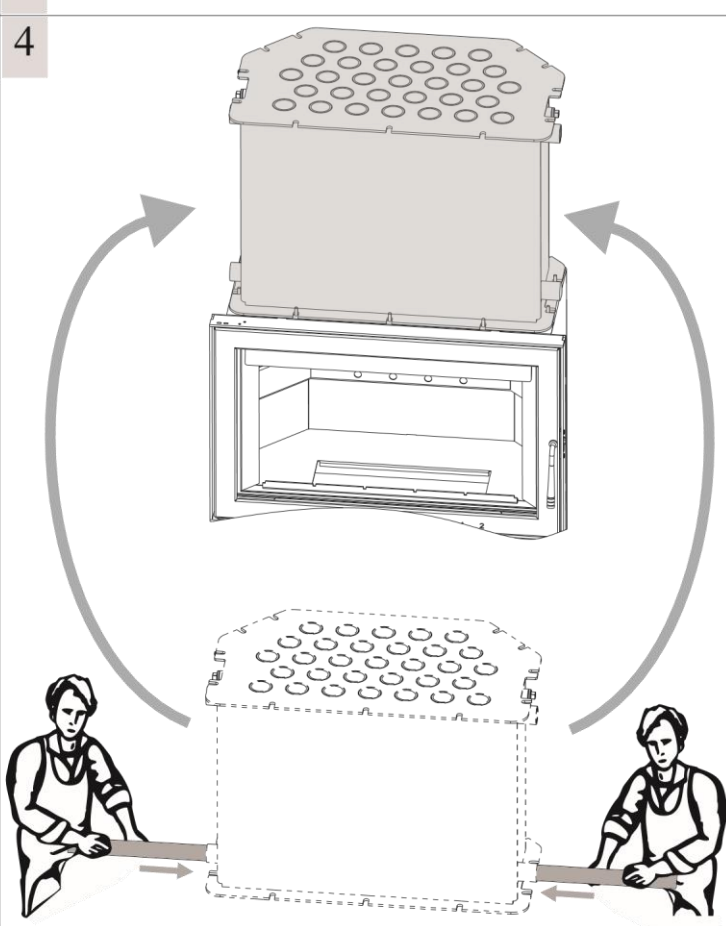

4

5

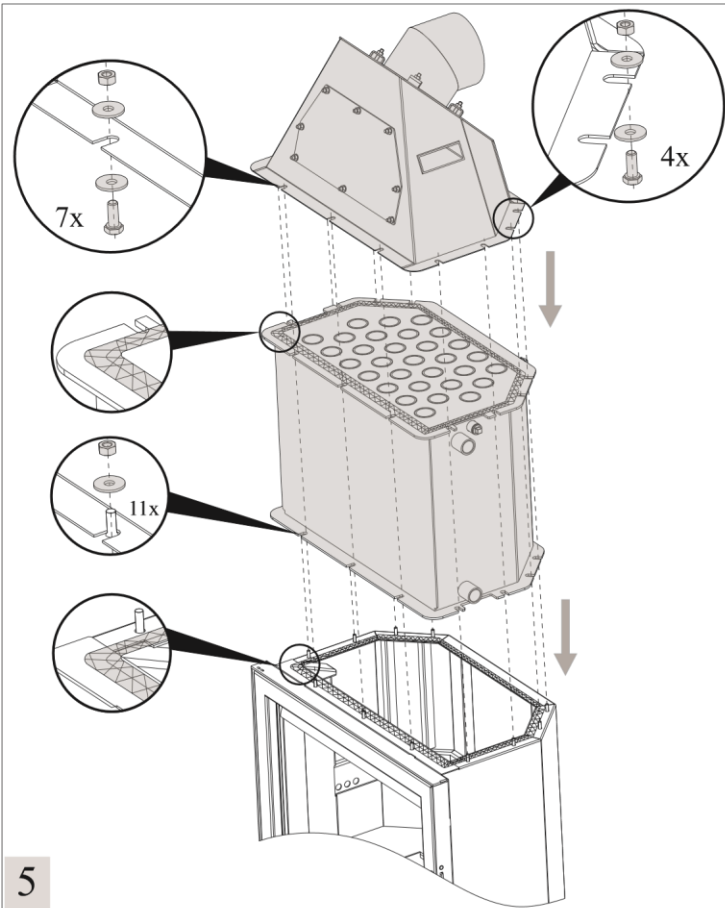

5

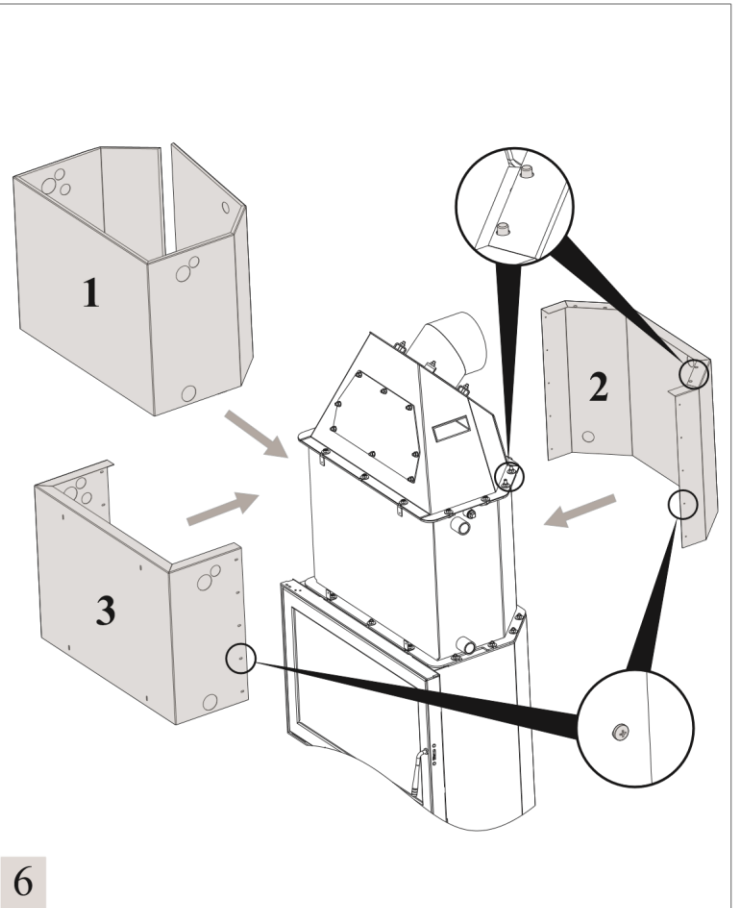

6

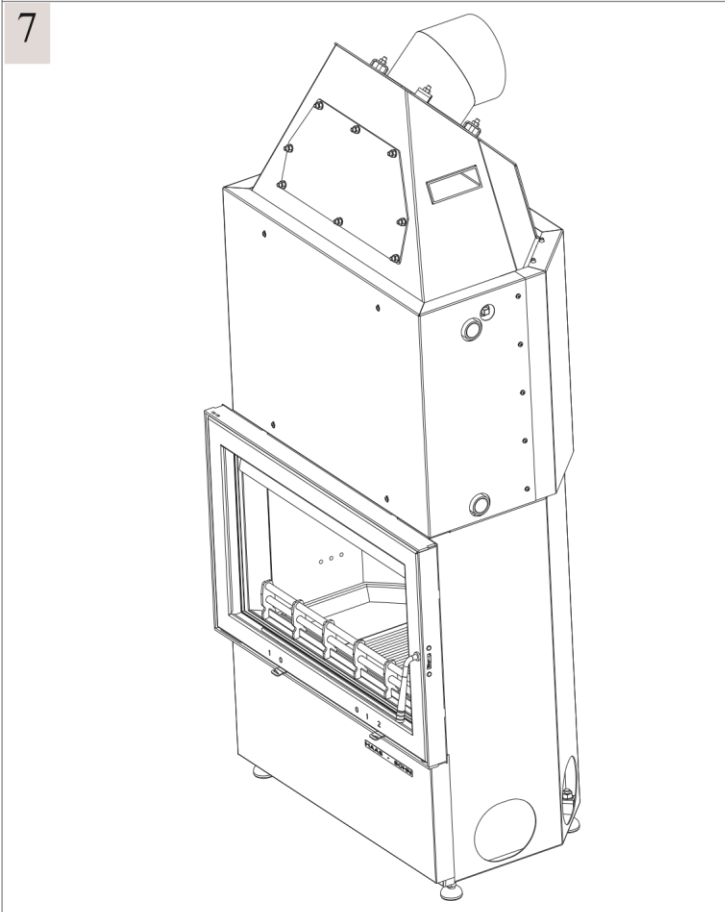

7

- Mounting adjustable feet
- Mounting sensor overheat protection

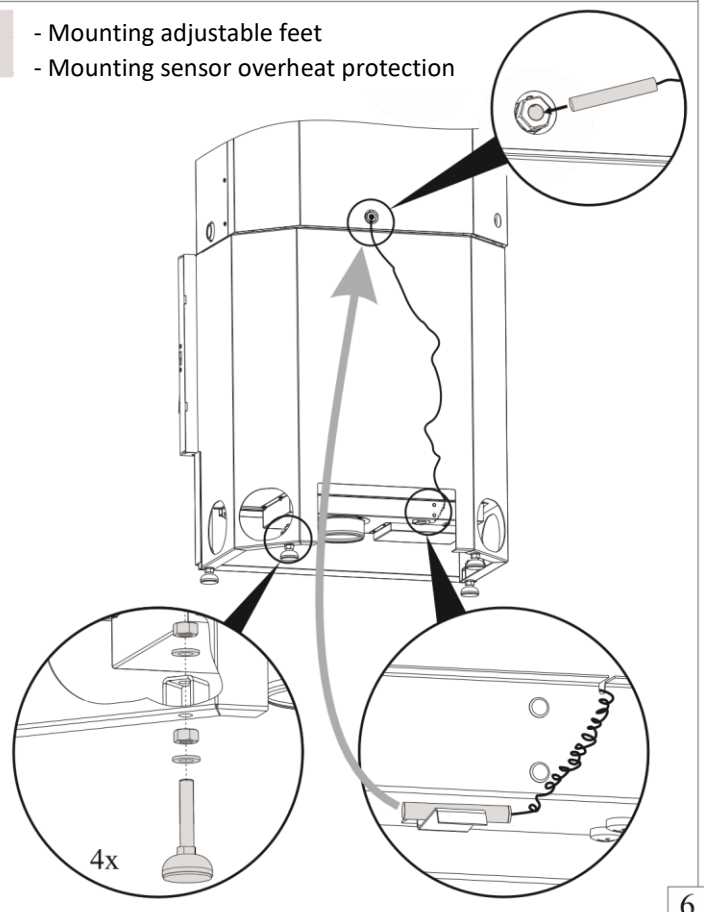

6

Fitting the combustion chamber lining

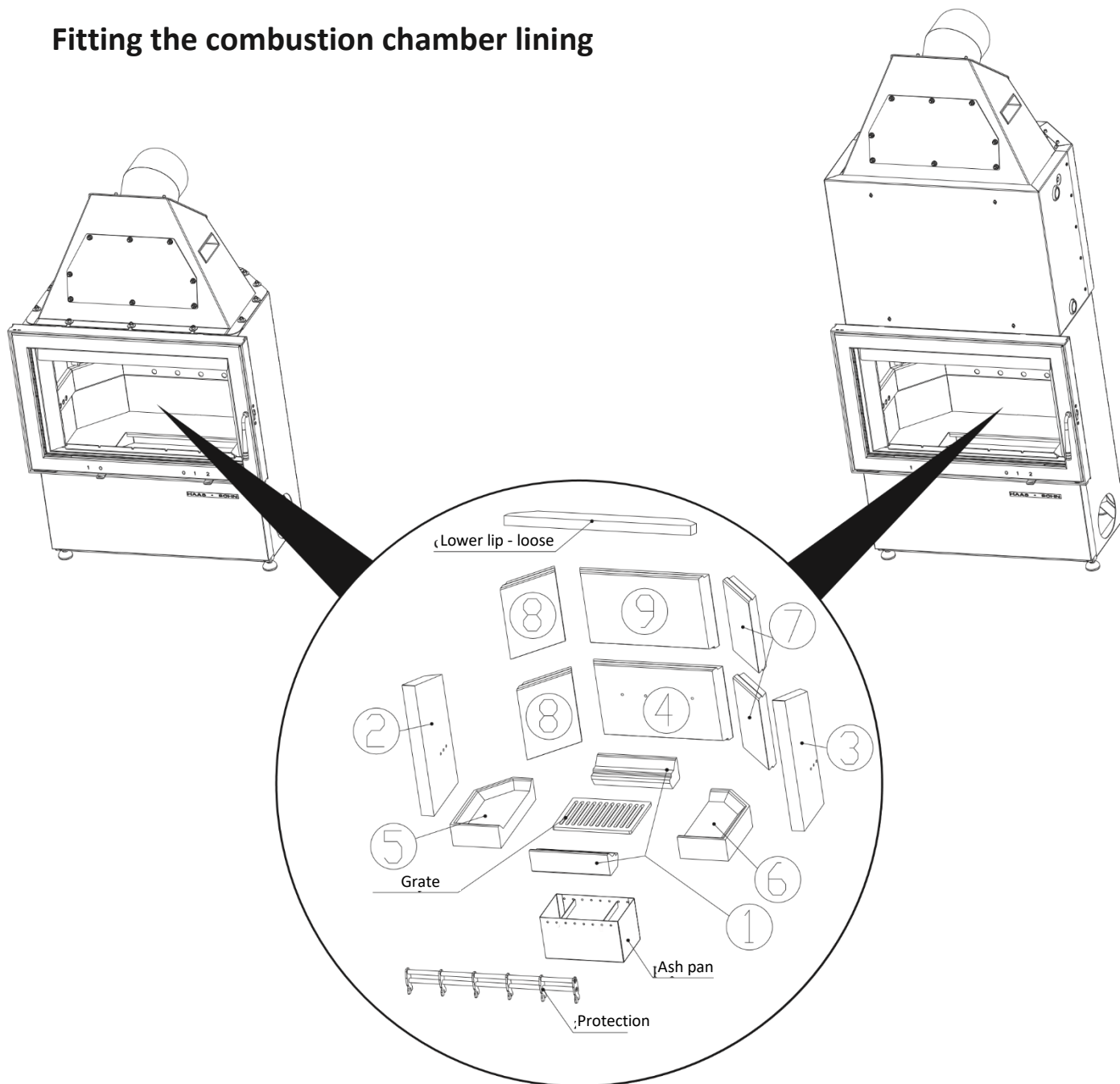

Fire-clay No.	Piece	Goods No.	Name	Piece	Goods No.
1	2	0618018075401	Lower lip - loose	1	0618018075701
2	1	0618018075501	Ash pan	1	0618018075410
3	1	0618018075502	Grate	1	0618018075070
4	1	0618018075505	Protection	1	0618618015820
5	1	0618018075506			
6	1	0618018075507			
7	2	0618018075508			
8	2	0618018075509			
9	1	0618018075511			